

Wunderlich Properties, LLC
Manufacturing Facility
Winslow, Maine

Evans Freimuth Architects, LLC provided Architectural, Structural, and Mechanical Engineering services for a 42,000 square foot Manufacturing Facility project at Wunderlich Properties, LLC in Winslow, Maine.

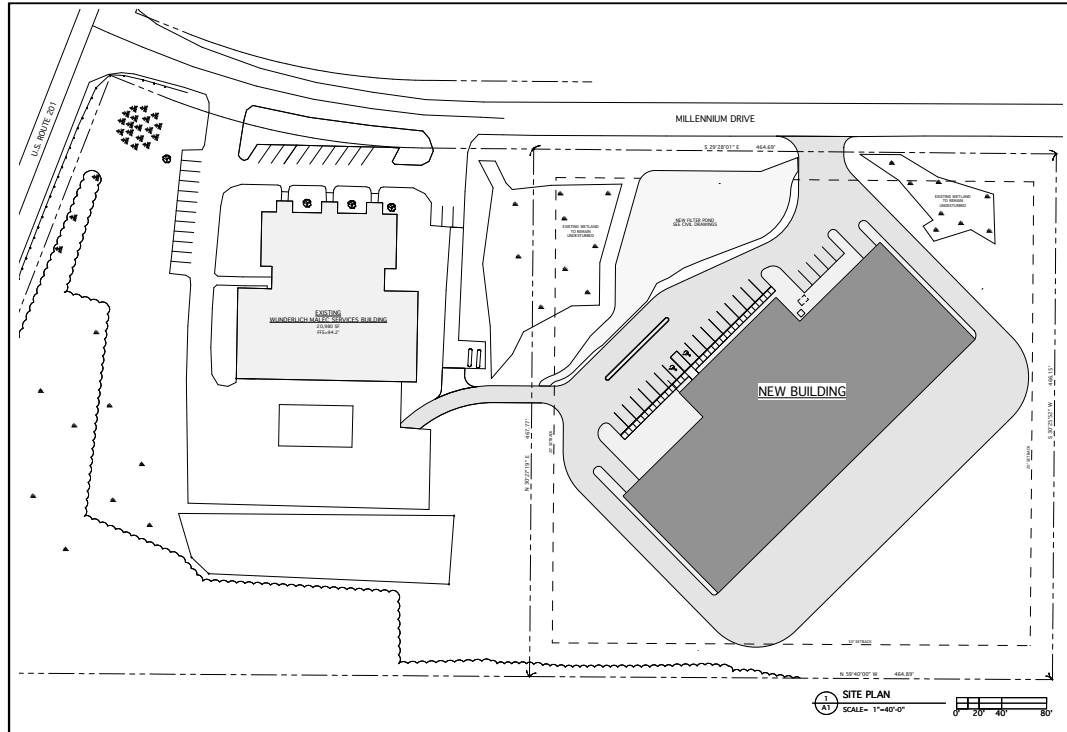

This project was designed to manufacture custom pre-manufactured Control Rooms and desalination devices. Some of the Control Rooms could weigh as much as 50 tons and be as large as a semi-trailer. This requirement gave this project the unique need to accommodate a traveling crane that could handle moving the Control Rooms during assembly and loading them on special semi-trailers within the building for shipping when they were finished.



Site planning was challenged by a site that contained untouchable wetlands, high bedrock, and the need for proper truck movements to serve the building. The building design had to deal with extraordinary snow loads and interior clear heights. These tall interior spaces also created the need for innovative solutions for heating and ventilating the room via hydronic underfloor heat and enormous diameter ceiling fans.